

CONSENT CALENDAR

SUBJECT: REQUEST TO ESTABLISH A FEE FOR STAFF TO PROVIDE THE OPTIONAL SERVICE OF REVIEWING PHOTOMETRIC PLANS

SOURCE: COMMUNITY DEVELOPMENT DEPARTMENT - PLANNING DIVISION



BACKGROUND: In the November 19, 2013, staff report regarding the proposed Development Ordinance, staff identified the need to follow up with an item for City Council's consideration regarding the review of photometric (i.e. site lighting) plans. Photometry is the science of the measurement of light, in terms of its perceived brightness to the human eye. The 2030 Porterville General Plan identified implementation policy LU-I-25 "Establish buffering requirements and performance standards intended to minimize harmful effects of excessive noise, light, glare, and other adverse environmental impacts." Section 300.07 Lighting and Illumination of the Porterville Development Ordinance provides standards for the use of outdoor artificial light that may have a detrimental effect on the environment. As building permits have been submitted, staff has requested photometric plans to identify the location of light sources and the resulting distribution of light.

A few members of the Porterville Development Ordinance Committee identified issues with providing photometric plans on small scale projects. Staff is proposing that, at the applicant's request, the City may provide the task of generating these photometric plans, for a fee based on staff time and the software required.

COMMENT: Staff has researched and tested software programs, and has estimated that the time required to provide this service is approximately two to three hours, dependent upon the size of the project. The software would cost the City approximately \$100 annually, which would be absorbed into the departmental operating budget. Staff is proposing a flat fee of \$158.00, which is based on two hours of staff time at the hourly rate of \$79.00. This is the cost in the current fee schedule for Community Development Department general research in excess of 30 minutes. A sample photometric plan is attached for your reference.

RECOMMENDATION: That the City Council direct staff to schedule a public hearing to consider adoption of a fee for photometric plan review services as an optional service to applicants.

ATTACHMENTS: Sample photometric plan

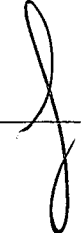
DD  CM  Appro./Funded 

Item No. 4

# STATISTICS

Description	Symbol	Avg	Max	Min	Max/Min	Avg/Min
Calc Zone #2	+	1.7 fc	3.0 fc	0.5 fc	8.3:1	4.3:1
TRASH ENCLOSURE	+	1.4 fc	2.3 fc	0.5 fc	4.5:1	2.9:1

SECTION LINE

CENTERLINE

SOUTH JAYE STREET

W. VANDALIA AVE.

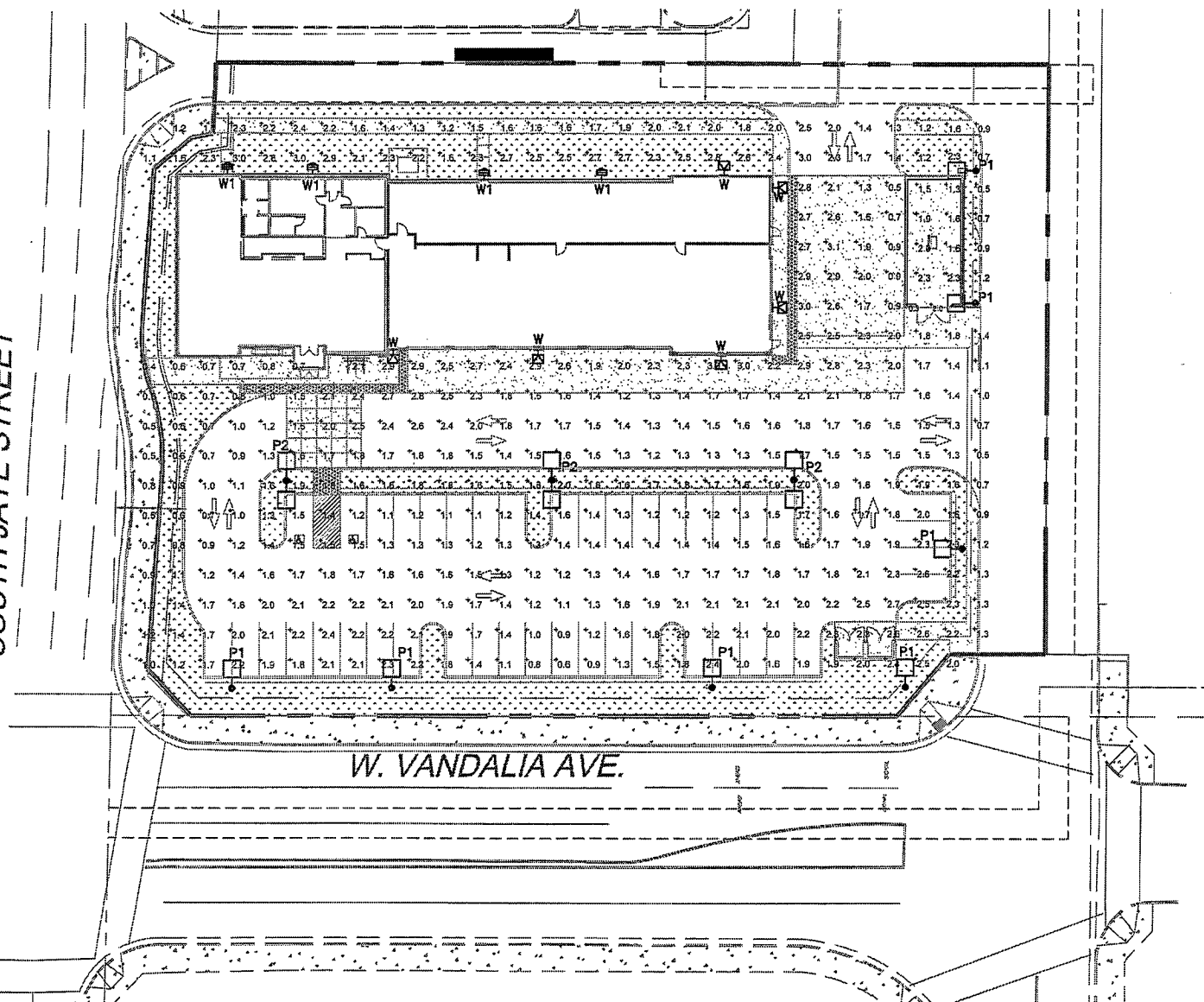

**ATTACHMENT  
ITEM NO.** |